

REGISTER NOW TO  
ACTIVATE YOUR

**5** YEAR  
WARRANTY\*

[www.purpleline.co.uk](http://www.purpleline.co.uk)  
01473 601200

Hitch Lock

PRODUCT CODE: **FHL400**

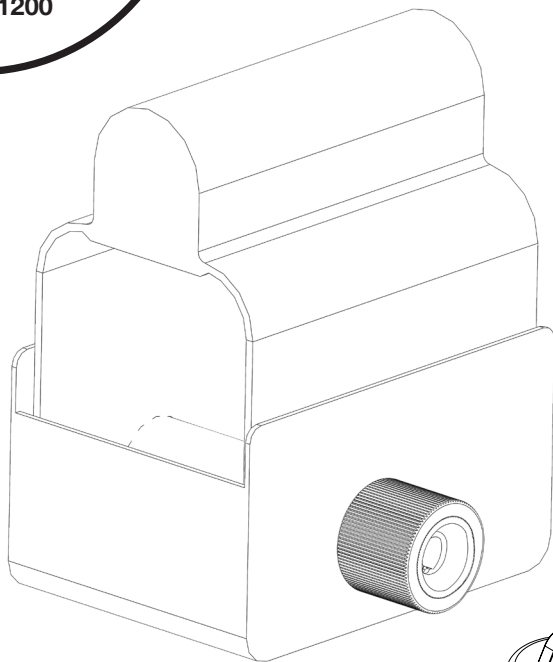
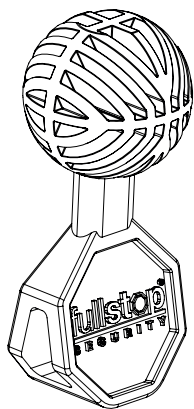

# PARTS IDENTIFICATION

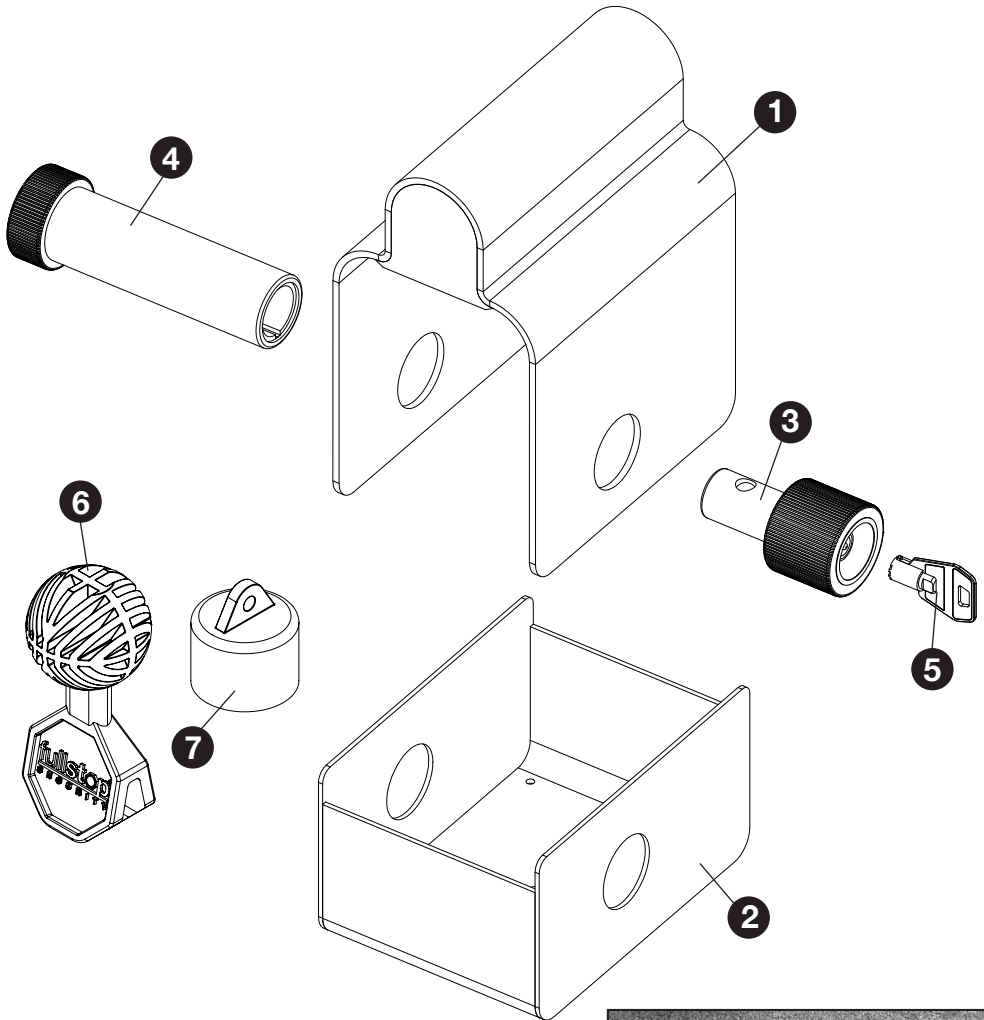

- |                        |                  |
|------------------------|------------------|
| 1. Main Body           | 5. Key (x3)      |
| 2. Base Section        | 6. Security Ball |
| 3. Male Lock Portion   | 7. Lock Cap      |
| 4. Female Lock Portion |                  |

Please store your keys in a safe place and remember to register within 14 days of purchase, either by returning your fully completed registration card, or online at [www.purpleline.co.uk/product-registration](http://www.purpleline.co.uk/product-registration)



## INTRODUCTION

The FullStop® Saracen Ultra Hitch Lock can be fitted when your vehicle is hitched or unhitched, but should never be fitted during transit. It is against the law in the UK to tow whilst using a Hitch Lock.

## FITTING WHEN HITCHED

Insert key (5) into Male Lock Portion (3), push and turn 90° clockwise to unlock.

If a stabiliser is fitted, lift the handle to the vertical position.

Position the Main Body (1) over the hitch handle ensuring the handle end is recessed fully into the enclosed end of the Main Body (1). Fit the Base Section (2) onto the bottom of the Main Body ensuring the holes line up with each other. Slide the Female Lock Portion (4) through all the holes.

Insert the Male Lock Portion (3) into the Female Lock Portion (4) and turn 90° anti-clockwise to lock.

Fit the protective Lock Cap (7).

If a stabiliser is fitted its handle may be pushed back down into position over the hitch lock.

## FITTING WHEN UN-HITCHED

Installation of the Saracen Hitch Lock when fitting onto an unhitched caravan, is identical except that the included Security Ball (6) must be inserted into your coupling to inhibit the caravan being hitched onto a vehicle.

## NOTE

It is highly recommended that a secondary security device (such as a wheel clamp) should be used to inhibit theft by some unconventional form of towing. Visit [www.purpleline.co.uk](http://www.purpleline.co.uk) for details of other products in the Fullstop Security range.

## MAINTENANCE

Fit the protective Lock Cap (7) over Male Locking Portion (3) to help prevent ingress of dirt or water.

Grease the lock face and ball bearings before first use, with a light oil such as 3-IN-ONE or equivalent.

Thereafter spray any moving parts of the lock body with a light oil such as 3-IN-ONE or equivalent every eight weeks.

# fullstop<sup>®</sup>

## S E C U R I T Y

### PRODUCT SPECIFICATION

FHL400				
Weight (kg)	Height (mm)	Width (mm)	Depth (mm)	Keys Supplied
3kg	170mm	100mm	140mm	3

Please store your keys in a safe place and remember to register your product.

**Registration is quick and simple, go to [www.purpleline.co.uk/product-registration](http://www.purpleline.co.uk/product-registration)**

**Please register within 14 days of purchase. Please retain your original purchase receipt.**

#### Disclaimer

If used properly, your FullStop<sup>®</sup> product will be an effective deterrent. However, nothing can stop the efforts of the most determined thief, and to this end no liability is accepted for any loss and/or damage caused by any illegal activity including theft or vandalism. Liability also not accepted for any loss and/or damage arising from misuse, unauthorised repair or alteration and failure to follow the user guide directions. No form of consequential loss what so ever will be accepted.



© Copyright 2017. Purple Line Limited, Peninsula Business Centre, Wherstead, Suffolk, IP9 2BB, UK

**[www.purpleline.co.uk](http://www.purpleline.co.uk)**  
**01473 601200**

Photographs for illustration purposes only. Actual product may differ slightly.  
Purple Line Limited reserve the right to alter product specification without prior notice.