



# SACACEN

Model. FHL300-KA

## Hitch Lock



### Disclaimer

If used properly, your FullStop® product will be an effective deterrent. However, nothing can stop the efforts of the most determined thief, and to this end no liability is accepted for any loss and/or damage caused by any illegal activity including theft or vandalism. Liability also not accepted for any loss and/or damage arising from misuse, unauthorised repair or alteration and failure to follow the user guide directions. No form of consequential loss what so ever will be accepted.



© Copyright 2010. Purple Line Limited.

Web: [www.purpleline.co.uk](http://www.purpleline.co.uk) E-mail: [admin@purpleline.co.uk](mailto:admin@purpleline.co.uk) Tel: 01473 601200

Photographs for illustration purposes only. Actual product may differ slightly.  
Purple line Limited reserve the right to alter product specification without prior notice.

**PLEASE READ THIS  
MANUAL BEFORE  
FIRST USE.**

**TIME INVESTED IN  
CORRECT FITMENT  
IS REPAID IN THE  
LEVEL OF SECURITY  
THAT IS ACHIEVED.**

## User Manual



## Parts Identification

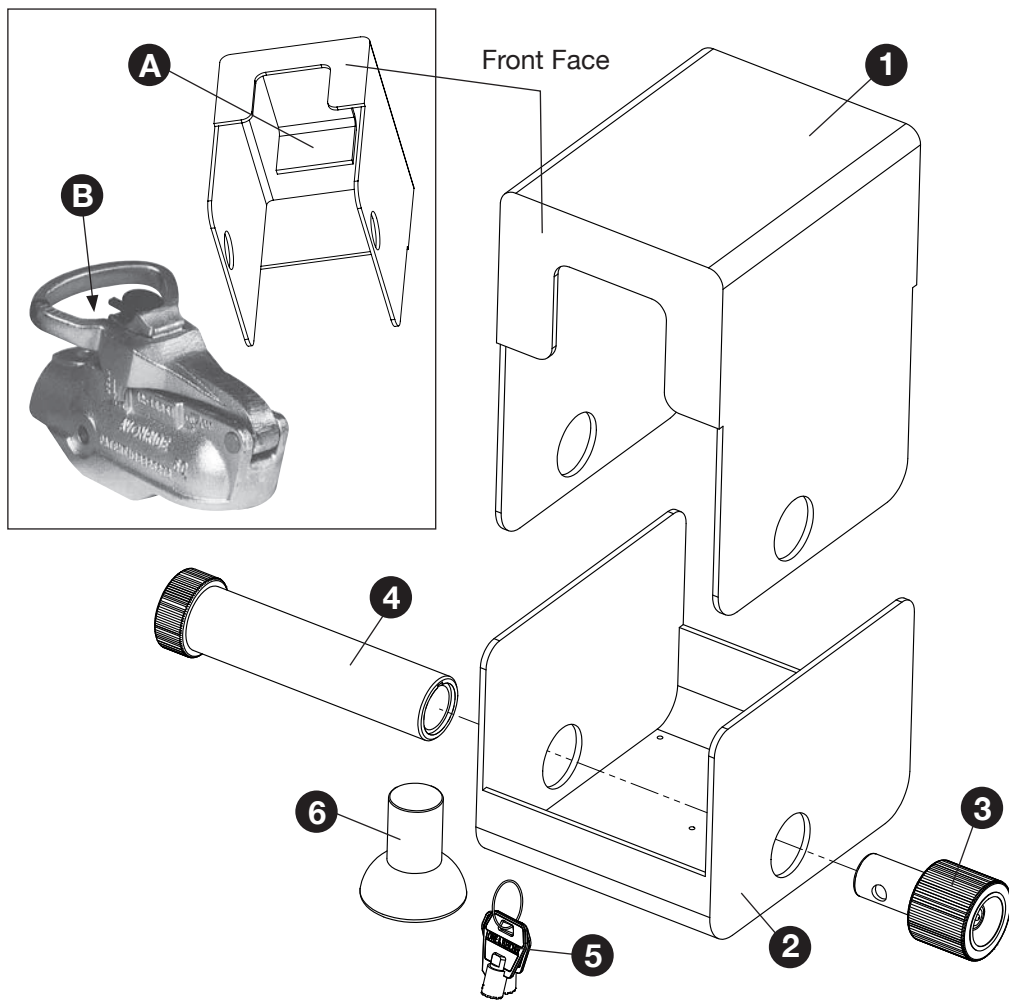

- |                      |                        |
|----------------------|------------------------|
| 1. Main Body         | 4. Female Lock Portion |
| 2. Base Section      | 5. Key (x2)            |
| 3. Male Lock Portion | 6. Security Ball       |

Please store your keys in a safe place and remember to return your fully completed registration card. Your key number is located on both of the keys supplied and will be required in order to purchase replacement keys.

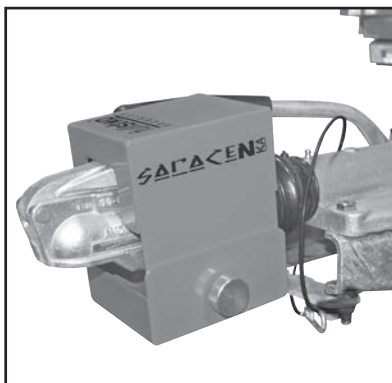

## Installation

The FullStop® Saracen Hitch Lock can be fitted when your trailer is hitched or unhitched, but must not be fitted during transit.

### Hitched

Insert key (5) into Male Lock Portion (3), push and turn 90° clockwise to unlock.

Position the Main Body (1) over the hitch handle ensuring the welded L-plate (A) sits within the loop of the handle (B) and that the Main Body (1) is facing the correct direction (see diagram). Fit the Base Section (2) onto the bottom of the Main Body ensuring the holes line up with each other. Slide the Female Lock Portion (4) through all the holes.

Insert the Male Lock Portion (3) into the Female Lock Portion (4) and turn 90° anti-clockwise to lock.

### Unhitched

Installation of the Saracen Hitch Lock when fitting onto an unhitched trailer, is identical except that the included Security Ball (6) must be inserted into your coupling to inhibit the trailer being hitched onto a vehicle.

### Note

It is highly recommended that a secondary security device (such as a wheel clamp) should be used to inhibit theft by some unconventional form of towing. Visit [www.purpleline.co.uk](http://www.purpleline.co.uk) for details of other products in the Fullstop Security range

### Maintenance

Spray the lock with a light oil such as WD-40 or equivalent every sixteen weeks.